



22 Burrows Vale
Brixworth, Northamptonshire

oriordanbond
TOWN & COUNTRY



22 Burrows Vale

Brixworth
NN6 9US

£310,000

A superb detached house, on a southerly facing plot, situated on the edge of the thriving village of Brixworth. The property has been beautifully maintained and extended by the existing owners.

Accommodation comprises entrance hall, cloakroom/WC, sitting room with vaulted ceiling, bi-folding door and skylight window, dining room, kitchen/breakfast room with integrated appliances, utility room, master bedroom with dressing room and en-suite, two further bedrooms and a re-fitted family bathroom. Outside is double width off road parking, part converted garage and a landscaped south facing rear garden. (A/1160/S)

- Extended three bedroom detached home
- En-suite and dressing room to master bedroom
- Two reception rooms
- Gas radiator heating
- Landscaped south facing rear garden
- Off road parking and part converted garage





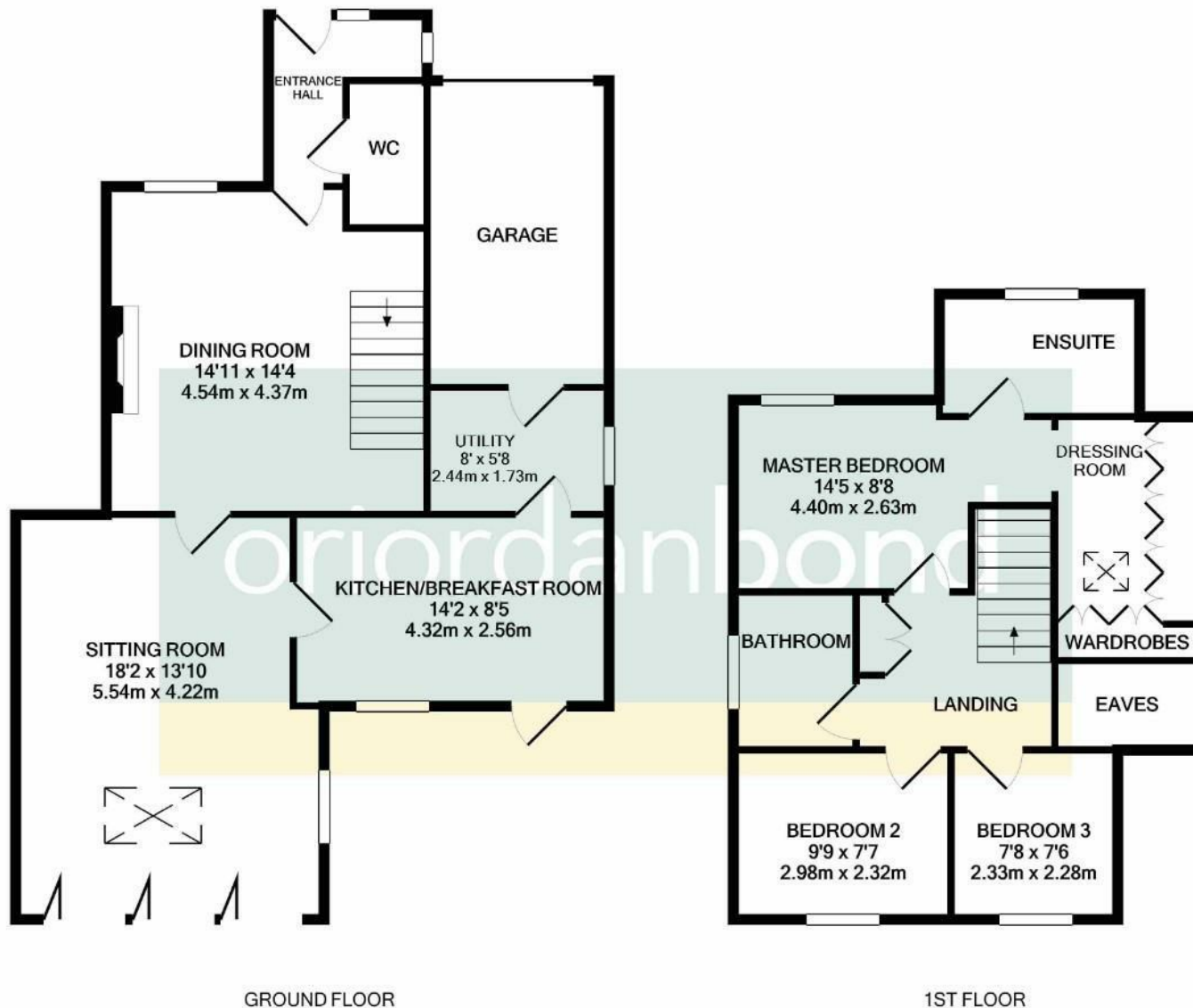

TOTAL APPROX. FLOOR AREA 1160 SQ.FT. (107.8 SQ.M.)

Whilst every attempt has been made to ensure the accuracy of the floor plan contained here, measurements of doors, windows, rooms and any other items are approximate and no responsibility is taken for any error, omission, or mis-statement. This plan is for illustrative purposes only and should be used as such by any prospective purchaser. The services, systems and appliances shown have not been tested and no guarantee as to their operability or efficiency can be given
Made with Metropix ©2021



Additional information

- Council Tax Band: D
- Energy Efficiency Rating: C

Viewing

Viewing strictly by appointment – details below

Disclaimer

O'Riordan Bond Estate Agents Limited has not tested apparatus, equipment, fittings or services and so cannot verify they are in working order. The buyer is advised to obtain verification from their solicitor or surveyor.

O'Riordan Bond Brixworth Sales

01604 880077

brixworth@oriordanbond.co.uk